



Score	Energy rating	Current	Potential
92+	A		
81-91	B		81 B
69-80	C	73 C	
55-68	D		
39-54	E		
21-38	F		
1-20	G		

Rydal Court, 17 Stonegrove, Edgware

2 Bed Apartment

Council tax band: F Tenure: Share of Freehold

Guide Price **£465,000** STC
FOR SALE



297 Hale Lane
Edgware
Middlesex
HA8 7AX

t: 020 8958 8958
f: 020 8958 2300
e: info@groveresidential.co.uk
w: www.groveresidential.co.uk

Company No: 9632012

VAT Reg. No: 217 0421 50

Registered Address: 297 Hale Lane, Edgware, Middlesex, HA8 7AX



Total Floor Area
101.33m²

Ground Floor

This floorplan has been prepared with all due care and attention, by Grove Residential for the convenience of intending buyers/tenants. Its accuracy is not guaranteed and it does not form any part of a contract. Purchasers/tenants should check by inspection its accuracy prior to signing a contract.

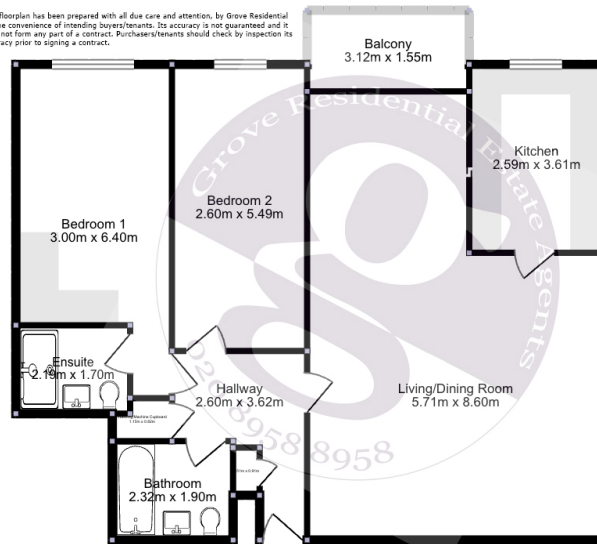

Key Features

- Ground Floor 2 Bedroom Apartment
- Rear Facing
- Separate Kosher Kitchen
- Spacious Living/Dining Room
- Two Double Bedrooms
- Family Bathroom & Ensuite

Summary

A ground floor 2 bedroom 2 bathroom apartment presented in excellent condition throughout, in this popular block on Stonegrove. The property has been fully refurbished a few years ago by its current owners, including, a new kitchen, new bathroom & ensuite, new boiler, new fuseboard and fully redecorated. The kitchen comprises 2 s

Score	Energy rating	Current	Potential
92+	A		
81-91	B		81 B
69-80	C	73 C	
55-68	D		
39-54	E		
21-38	F		
1-20	G		



The particulars have been prepared with all due care and attention, for the convenience of intending purchasers/tenants. Their accuracy is not guaranteed and they do not form any part of a contract. Purchasers/tenants should check by inspection the accuracy of the particulars prior to signing a contract.