



Leeland Way, Neasden

2 Bed Flat

Council tax band: TBC Tenure: Assured Shorthold Tenancy

£1,495 per month
TO RENT



297 Hale Lane
Edgware
Middlesex
HA8 7AX
t: 020 8958 8958
f: 020 8958 2300
e: info@groveresidential.co.uk
w: www.groveresidential.co.uk

Company No: 9632012 VAT Reg. No: 217 0421 50
Registered Address: 297 Hale Lane, Edgware, Middlesex, HA8 7AX



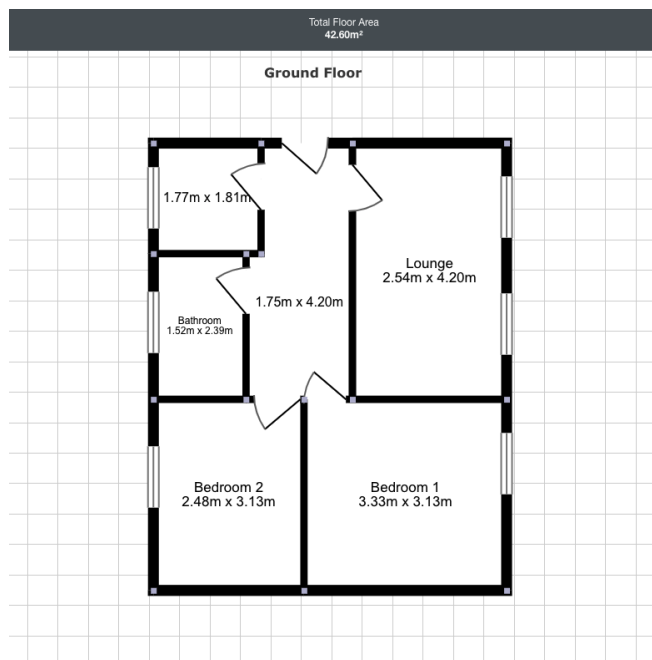

Key Features

- 2 Double Bedrooms
- Lounge/Dining Room
- New kitchen
- New Bathroom
- Gas Central Heating
- New Carpets

Summary

A refurbished two bedroom 2nd floor apartment set in this central location near amenities and transport facilities. The property has a generous lounge and two good size bedrooms plus the benefit of gas central heating and double glazing.

Call 0208 958 8958 to arrange a viewing !

Energy Efficiency Rating			
Score	Energy rating	Current	Potential
92+	A		
81-91	B		
69-80	C		80 C
55-68	D	70 C	
39-54	E		
21-38	F		
1-20	G		

The particulars have been prepared with all due care and attention, for the convenience of intending purchasers/tenants. Their accuracy is not guaranteed and they do not form any part of a contract. Purchasers/tenants should check by inspection the accuracy of the particulars prior to signing a contract.